

## REQUEST FOR BOARD ACTION

### HENDERSONCOUNTY BOARD OF COMMISSIONERS

MEETING DATE: February 5, 2007

SUBJECT: Petition for addition to State Road system.

ATTACHMENTS: (1) Copy of petition for Bloomingdale subdivision.  
(2) Map of Bloomingdale subdivision  
(3) Copy of petition for McLean Farms Cross Creek subdivision  
(4) Map of McLean Farms Cross Creek subdivision

SUMMARY OF REQUEST: Recommend approval of the attached petitions. It has been the practice of this Board to accept road petitions and forward them to NC Department of Transportation for their review. It has also been the practice of the Board not to ask NCDOT to change the priority for roads on the paving priority list.

#### BOARD ACTION REQUESTED:

Recommend approving petitions and forwarding to NCDOT

Suggested Motion: I move that the Board approve the petitions and forward them to NCDOT for action.

**North Carolina Department of Transportation  
Division of Highways  
Petition for Road Addition**

**RECEIVED**

MAY 5 2006

ROUTE  
DIVISION 14 - DISTRICT 1

**ROADWAY INFORMATION:** (Please Print/Type)

County: Henderson Road Name: Bloomingsdale Drive  
(Please list additional street names and lengths on the back of this form.)

Subdivision Name: Bloomingsdale Length (miles): 2/8

Number of occupied homes having street frontage: 6 Location 6/10

miles miles N  S  E  W  of the intersection of Route Howard Gap and Route Jackson R  
(Check one) (SR, NC, US) (SR, NC, US)

We, the undersigned, being property owners and/or developers of Bloomingsdale in Henderson County, do hereby request the Division of Highways to add the above described road.

**CONTACT PERSON:** Name and Address of First Petitioner. (Please Print/Type)

Name: Edgar S Holland Phone Number: 828-777-6777

Street Address: \_\_\_\_\_

Mailing Address: P.O. Box 415 - Fletcher, NC 28737

**PROPERTY OWNERS**

<u>Name</u>	<u>Mailing Address</u>	<u>Telephone</u>
<u>John + Pam Hughes</u>	<u>46 Beale Court</u>	<u>828-275-2902</u>
<u>Suzanne Holbert</u>	<u>16 Beale Court</u>	<u>828-684-2300</u>
<u>Andy + Donna Cope</u>	<u>101 Bloomingsdale Dr</u>	<u>828-779-2740</u>
<u>Brent Culbertson</u>	<u>170 Bloomingsdale Dr</u>	<u>828-684-3277</u>
<u>Alex Stamatoovich</u>	<u>60 Bloomingsdale Dr</u>	<u>704-458-7911</u>
<u>Ernie Taylor</u>	<u>124 Bloomingsdale Dr</u>	<u>828-687-9772</u>

**INSTRUCTIONS FOR COMPLETING PETITION:**

1. Complete Information Section
2. Identify Contact Person (This person serves as spokesperson for petitioner(s)).
3. Attach four (4) copies of recorded subdivision plat or property deeds, which refer to candidate road.
4. Adjoining property owners and/or the developer may submit a petition. Subdivision roads with prior NCDOT review and approval only require the developer's signature.
5. If submitted by the developer, encroachment agreements from all utilities located within the right of way shall be submitted with the petition for Road addition. However, construction plans may not be required at this time.
6. Submit to District Engineer's Office.

**FOR NCDOT USE ONLY: Please check the appropriate block**

Rural Road     Subdivision platted prior to October 1, 1975     Subdivision platted after October 1, 1975

REQUIREMENTS FOR ADDITION

If this road meets the requirements necessary for addition, we agree to grant the Department of Transportation a right-of-way of the necessary width to construct the road to the minimum construction standards of the NCDOT. The right-of-way will extend the entire length of the road that is requested to be added to the state maintained system and will include the necessary areas outside of the right-of-way for cut and fill slopes and drainage. Also, we agree to dedicate additional right-of-way at intersections for sight distance and design purposes and execute said right-of-way agreement forms that will be submitted to us by representatives of the NCDOT. The right-of-way shall be cleared at no expense to the NCDOT, which includes the removal of utilities, fences, other obstructions, etc.

General Statute 136-102.6 (see page 29 for Statute) states that any subdivision recorded on or after October 1, 1975, must be built in accordance with NCDOT standards in order to be eligible for addition to the State Road System.

<u>ROAD NAME</u>	<u>HOMES</u>	<u>LENGTH</u>	<u>ROAD NAME</u>	<u>HOMES</u>	<u>LENGTH</u>
Bloomington A	6	$\frac{2}{10}$			
Beale Ct	4	400 ft	(add per phone conversation) of 1-18-07 Curtis Griffin		

**DATE: JANUARY 18, 2007**

**TO: WHOM IT MAY CONCERN**

**FROM: ED HOLLAND BUILDERS, INC.**

**SUBJECT: BLOOMINGDALE SUBDIVISION**

**PLEASE INCLUDE BEALE COURT AS ONE OF THE ROADS IN THE BLOOMINGDALE SUBDIVISION TO BE PETITIONED FOR STATE MAINTENANCE.**

SINCERELY

ED HOLLAND

Text to  
697-4658

# Bloomington Subdivision State Road Addition Request

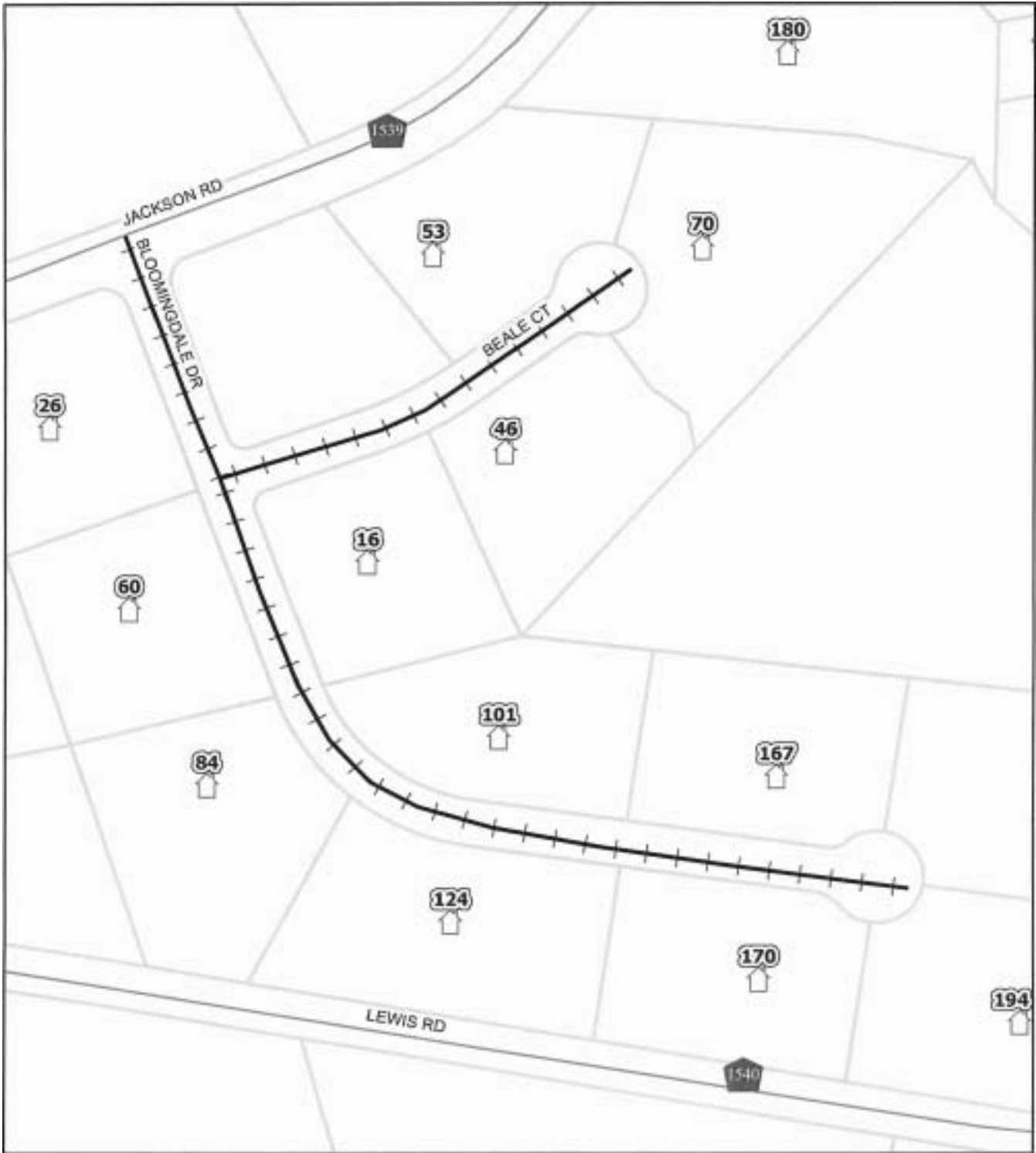

## Legend

- Driveway
- +— Proposed Roads to be Added
- Street



**North Carolina Department of Transportation  
Division of Highways  
Petition for Road Addition**



**ROADWAY INFORMATION:** (Please Print/Type)

county: Henderson Road Name: Baler  
(Please list Additional street names and lengths on the back of this form.)

Subdivision Name: McLean Farms Cross Creek Tr Length (miles): .55

Number of occupied homes having street frontage: 16 Location Roy Hill

miles miles N  S  E  W  of the intersection of Route NC 280 and Route 1716  
(Check one) (SR, NC, US) (SR, NC, US)

We, the undersigned, being property owners and/or developers of \_\_\_\_\_ in \_\_\_\_\_ County, do hereby request the Division of Highways to add the above described road.

**CONTACT PERSON:** Name and Address of First Petitioner. (Please Print/Type)

Name: Randy Austin Phone Number: 890-3090

Street Address: 56 West Chasis Court

Mailing Address: 56 West Chasis Court Mills River NC 28750

**PROPERTY OWNERS**

	<u>Name</u>	<u>Mailing Address</u>	<u>Telephone</u>
1	Randy Austin	56 West Chasis Court	890-3090
2	HERMANN W. REISSER	109 ARLEK DR	890 5677
3	Robert B. McQuinn	216 E. Chasis Court	891-6070
4	Thomas R. Adams	106 E Chasis Ct	890-4390
5	Mark E. Powell	65 E. Chasis Court	891-4188
6	ELISABETH JOHNSON	65 W CHASIS CT	891-5751
7	James R Hyatt	21 E Chasis Ct	890-3260
8	J. Raymond Hull	248 E Chasis Ct.	890-4388

**INSTRUCTIONS FOR COMPLETING PETITION:**

1. Complete Information Section
2. Identify Contact Person (This person serves as spokesperson for petitioner(s)).
3. Attach four (4) copies of recorded subdivision plat or property deeds, which refer to candidate road.
4. Adjoining property owners and/or the developer may submit a petition. Subdivision roads with prior NCDOT review and approval only require the developer's signature.
5. If submitted by the developer, encroachment agreements from all utilities located within the right of way shall be submitted with the petition for Road addition. However, construction plans may not be required at this time.
6. Submit to District Engineer's Office.

**FOR NCDOT USE ONLY:** Please check the appropriate block

- Rural Road   
  Subdivision platted prior to October 1, 1975   
  Subdivision platted after October 1, 1975

**REQUIREMENTS FOR ADDITION**

If this road meets the requirements necessary for addition, we agree to grant the Department of Transportation a right-of-way of the necessary width to construct the road to the minimum construction standards of the NCDOT. The right-of-way will extend the entire length of the road that is requested to be added to the state maintained system and will include the necessary areas outside of the right-of-way for cut and fill slopes and drainage. Also, we agree to dedicate additional right-of-way at intersections for sight distance and design purposes and execute said right-of-way agreement forms that will be submitted to us by representatives of the NCDOT. The right-of-way shall be cleared at no expense to the NCDOT, which includes the removal of utilities, fences, other obstructions, etc.

General Statute 136-102.6 (see page 29 for Statute) states that any subdivision recorded on or after October 1, 1975, must be built in accordance with NCDOT standards in order to be eligible for addition to the State Road System.

<u>ROAD NAME</u>	<u>HOMES</u>	<u>LENGTH</u>	<u>ROAD NAME</u>	<u>HOMES</u>	<u>LENGTH</u>
E Chasis Court #1		.25 miles			
W Chasis Court		100 ft			

4 Debbie Freeman 111 E Chasis Ct 891-5464  
Mills River NC 28759

10 Dan Dorfman 101 Baker Dr 775-5740

11 Steven Cassano 178 E Chasis Ct 891-3586

12 H. Melrow Ownby Jr 674-0440  
101 Baker Dr.

13 Michael & Kimberly Cole 891-1301  
30 E. Chasis Ct.

14 Dan Butts 890-1593  
342 Ray Hill Rd

15 ROBERT & KAREN KATIGSMANN 388-1921  
110 Baker Dr

16 Donald + Tonya Redden 891-4681  
31 W. Chasis Ct.

875

196  
77  
5  
20  
8  
5  
10/20/2001



# McLean Farms Cross Creek Subdivision State Road Addition Request

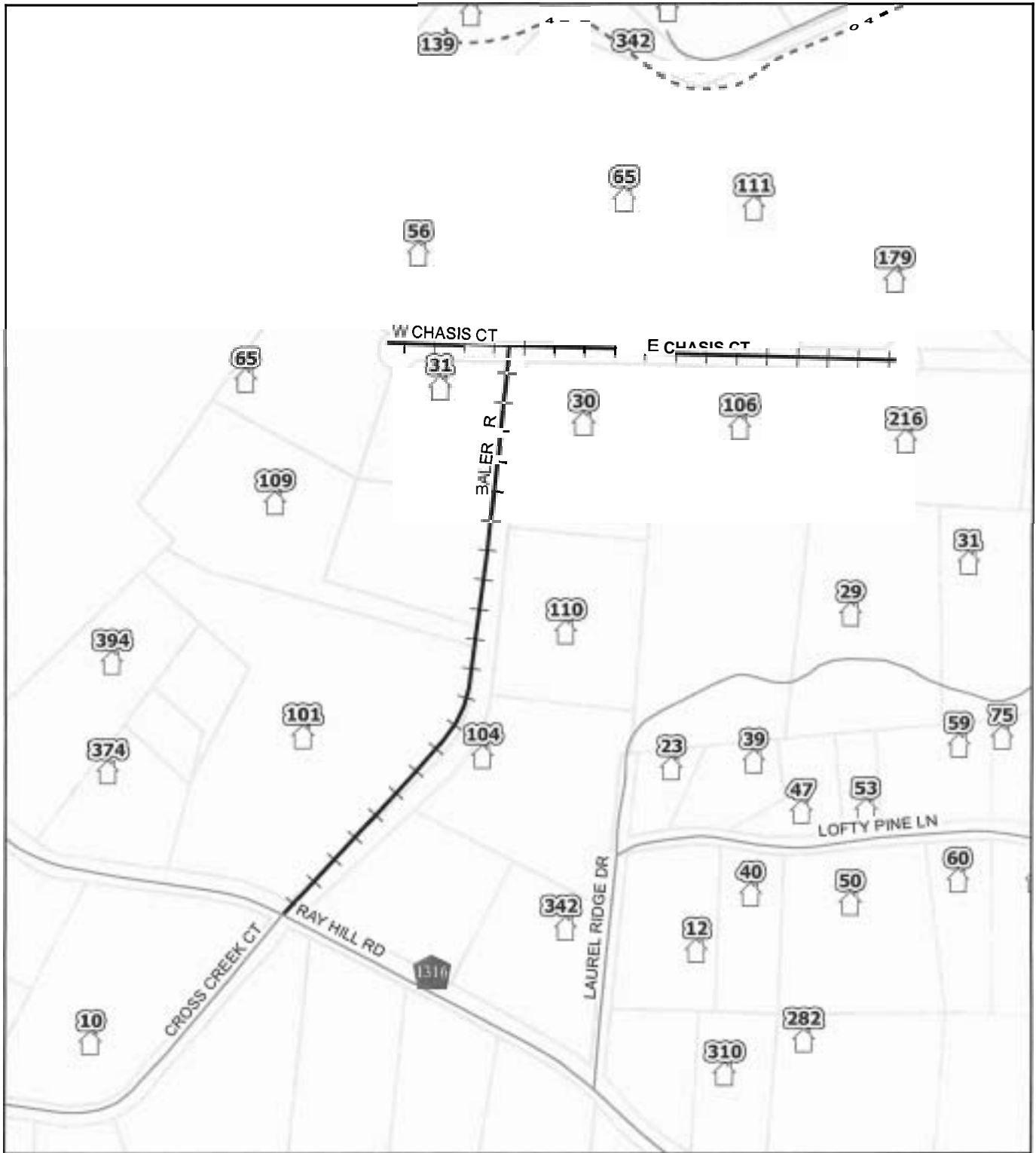

## Legend

- Driveway
- +— Proposed Roads to be Added
- Street

